

PALMER SQUARE WEST CONDOMINIUMS

Block	Lot	Qualifier	Level	Area	Address
20.08	3.04	C3D	3rd Floor	820 S.F.	3 PALMER SQ. WEST UNIT D
20.08	3.05	C3E	3rd Floor	640 S.F.	3 PALMER SQ. WEST UNIT E
20.08	3.06	C3F	3rd Floor	563 S.F.	3 PALMER SQ. WEST UNIT F
20.08	9.05	C9E	3rd Floor	306 S.F.	9 PALMER SQ. WEST UNIT E
20.08	9.06	C9F	3rd Floor	306 S.F.	9 PALMER SQ. WEST UNIT F
20.08	9.07	C9G	3rd Floor	304 S.F.	9 PALMER SQ. WEST UNIT G
20.08	9.08	C9H	3rd Floor	304 S.F.	9 PALMER SQ. WEST UNIT H
20.08	15.04	C15D	3rd Floor	620 S.F.	15 PALMER SQ. WEST UNIT D
20.08	15.05	C15E	3rd Floor	612 S.F.	15 PALMER SQ. WEST UNIT E
20.08	15.06	C15F	3rd Floor	773 S.F.	15 PALMER SQ. WEST UNIT F
20.08	25.04	C25D	3rd Floor	648 S.F.	25 PALMER SQ. WEST UNIT D
20.08	25.05	C25E	3rd Floor	635 S.F.	25 PALMER SQ. WEST UNIT E
20.08	25.06	C25F	3rd Floor	864 S.F.	25 PALMER SQ. WEST UNIT F
20.08	31.03	C31C	3rd Floor	480 S.F.	31 PALMER SQ. WEST UNIT C
20.08	31.04	C31D	3rd Floor	480 S.F.	31 PALMER SQ. WEST UNIT D
20.08	37.03	C37C	3rd Floor	496 S.F.	37 PALMER SQ. WEST UNIT C
20.08	37.04	C37D	3rd Floor	496 S.F.	37 PALMER SQ. WEST UNIT D
20.08	43.05	C43E	3rd Floor	290 S.F.	43 PALMER SQ. WEST UNIT E
20.08	43.06	C43F	3rd Floor	375 S.F.	43 PALMER SQ. WEST UNIT F
20.08	48.05	C48E	3rd Floor	290 S.F.	48 NASSAU STREET UNIT E
20.08	48.06	C48F	3rd Floor	265 S.F.	48 NASSAU STREET UNIT F
20.08	48.07	C48G	3rd Floor	260 S.F.	48 NASSAU STREET UNIT G
20.08	48.08	C48H	3rd Floor	260 S.F.	48 NASSAU STREET UNIT H
20.08	49.07	C49G	3rd Floor	425 S.F.	49 PALMER SQ. WEST UNIT G
20.08	49.08	C49H	3rd Floor	232 S.F.	49 PALMER SQ. WEST UNIT H
20.08	49.09	C49I	3rd Floor	280 S.F.	49 PALMER SQ. WEST UNIT I
20.08	49.10	C49J	3rd Floor	266 S.F.	49 PALMER SQ. WEST UNIT J
20.08	49.11	C49K	3rd Floor	232 S.F.	49 PALMER SQ. WEST UNIT K
20.08	49.12	C49L	3rd Floor	238 S.F.	49 PALMER SQ. WEST UNIT L
20.08	55.05	C55E	3rd Floor	396 S.F.	55 PALMER SQ. WEST UNIT E
20.08	55.06	C55F	3rd Floor	400 S.F.	55 PALMER SQ. WEST UNIT F
20.08	61.03	C61C	3rd Floor	465 S.F.	61 PALMER SQ. WEST UNIT C
20.08	61.04	C61D	3rd Floor	465 S.F.	61 PALMER SQ. WEST UNIT D
20.08	71.05	C71E	3rd Floor	669 S.F.	71 PALMER SQ. WEST UNIT E
20.08	71.06	C71F	3rd Floor	319 S.F.	71 PALMER SQ. WEST UNIT F
20.08	71.07	C71G	3rd Floor	1,024 S.F.	71 PALMER SQ. WEST UNIT G
20.08	87.04		3rd Floor	0 S.F.	44 NASSAU STREET
20.09	3.07	C3G	4th Floor	820 S.F.	3 PALMER SQ. WEST UNIT G
20.09	3.08	C3H	4th Floor	640 S.F.	3 PALMER SQ. WEST UNIT H
20.09	9.09	C9I	4th Floor	534 S.F.	9 PALMER SQ. WEST UNIT I
20.09	9.10	C9J	4th Floor	534 S.F.	9 PALMER SQ. WEST UNIT J
20.09	15.07	C15G	4th Floor	840 S.F.	15 PALMER SQ. WEST UNIT G
20.09	25.07	C25G	4th Floor	625 S.F.	25 PALMER SQ. WEST UNIT G
20.09	25.08	C25H	4th Floor	500 S.F.	25 PALMER SQ. WEST UNIT H
20.09	25.09	C25I	4th Floor	620 S.F.	25 PALMER SQ. WEST UNIT I
20.09	44.01	C44A	4th Floor	264 S.F.	44 NASSAU STREET UNIT A
20.09	44.02	C44B	4th Floor	272 S.F.	44 NASSAU STREET UNIT B
20.09	44.03	C44C	4th Floor	483 S.F.	44 NASSAU STREET UNIT C
20.09	44.04	C44D	4th Floor	280 S.F.	44 NASSAU STREET UNIT D
20.09	44.05	C44E	4th Floor	282 S.F.	44 NASSAU STREET UNIT E
20.09	44.06	C44F	4th Floor	273 S.F.	44 NASSAU STREET UNIT F
20.09	48.09	C48I	4th Floor	500 S.F.	48 NASSAU STREET UNIT I
20.09	48.10	C48J	4th Floor	475 S.F.	48 NASSAU STREET UNIT J
20.09	49.13	C49M	4th Floor	325 S.F.	49 PALMER SQ. WEST UNIT M
20.09	49.14	C49N	4th Floor	275 S.F.	49 PALMER SQ. WEST UNIT N
20.09	49.15	C49O	4th Floor	635 S.F.	49 PALMER SQ. WEST UNIT O
20.10	44.07	C44G	5th Floor	264 S.F.	44 NASSAU STREET UNIT G
20.10	44.08	C44H	5th Floor	264 S.F.	44 NASSAU STREET UNIT H
20.10	44.09	C44I	5th Floor	483 S.F.	44 NASSAU STREET UNIT I
20.10	44.10	C44J	5th Floor	280 S.F.	44 NASSAU STREET UNIT J
20.10	44.11	C44K	5th Floor	272 S.F.	44 NASSAU STREET UNIT K
20.10	44.12	C44L	5th Floor	273 S.F.	44 NASSAU STREET UNIT L

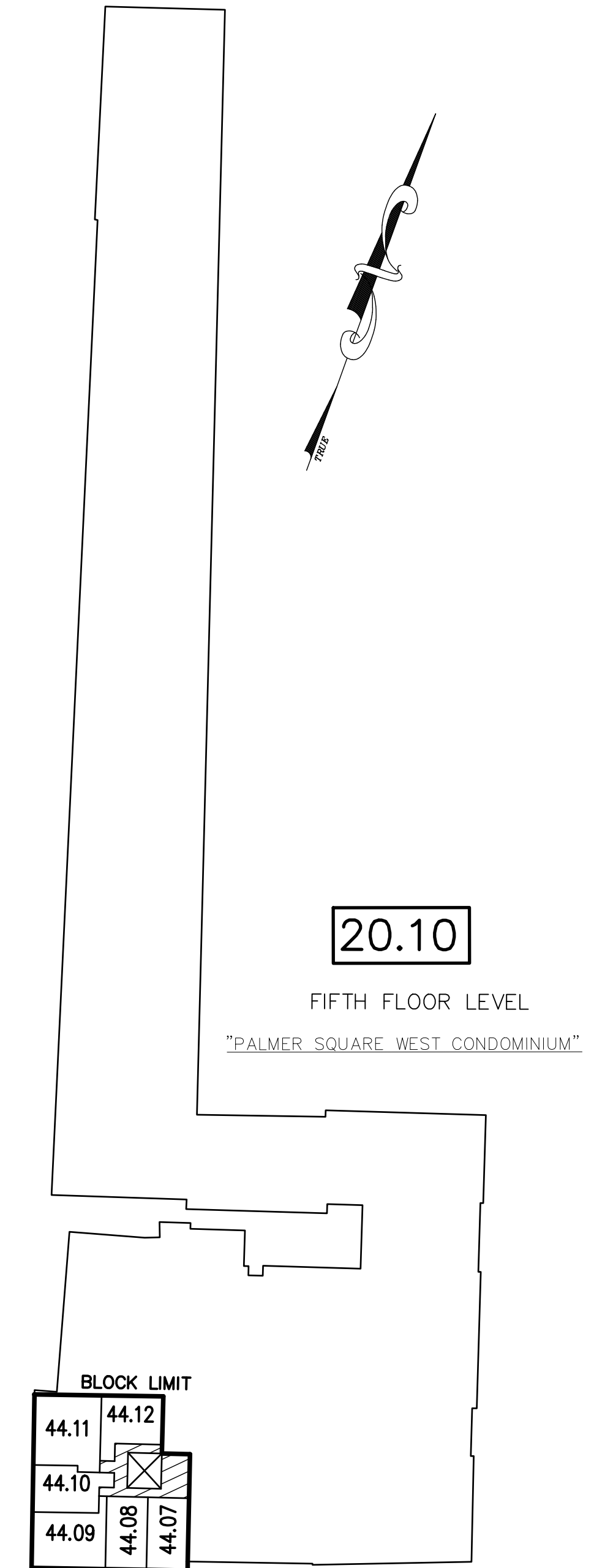
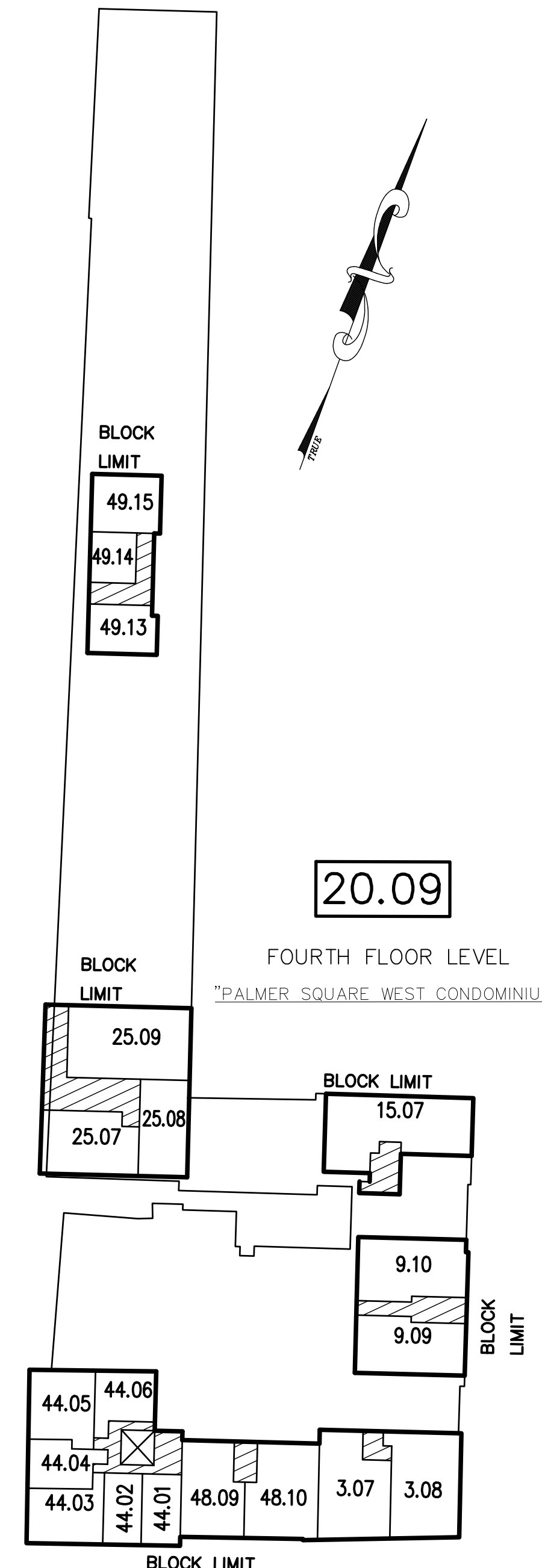
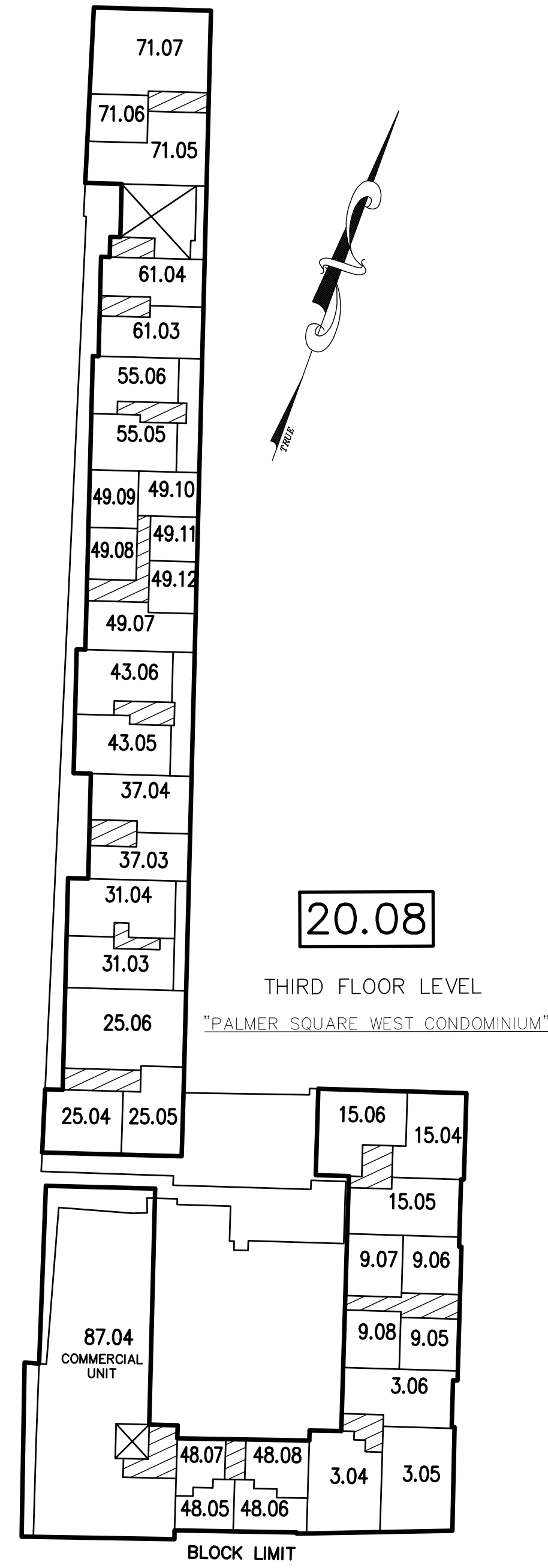

REVISIONS		
DATE	NAME	NO.
10/1/14	GREGORY SANDUSKY	GB36758

This map has been redrawn using Computer Aided Drafting/Design (CAD/D) based on the map prepared by Kenneth R. Raikie, August, 2011.

THIS MAP SHEET HAS BEEN FORMALLY CERTIFIED FOR CONSOLIDATION ON 12/10/2012, ASSIGNED SERIAL NUMBER 1012, AND SIGNED BY SUE DAVIDSON (CTA SUPERVISING FIELD REPRESENTATIVE FOR THE STATE OF NEW JERSEY). A COPY OF THE ORIGINALLY APPROVED MAPS ARE ON FILE AT THE MUNICIPALITY OF PRINCETON LOCATED AT 400 WITHERSPOON STREET, PRINCETON, N.J. THE NEW JERSEY STATE DIVISION OF TAXATION IS RETAINING THE OFFICIAL APPROVED MAPS.

TAX MAP PRINCETON
 MERCER COUNTY, NEW JERSEY
 SCALE: 1" = 40' OCTOBER, 2012
 DAVID B. DIXON, PLS
 Professional Land Surveyor N.J. Lic. No.27282
 OMLAND ENGINEERING ASSOCIATES, INC.
 CEDAR KNOLLS, NEW JERSEY
 To Show Conditions as of October, 2012