



RESOLUTION 21-169

**Resolution to Abolish Curbside Pickup on Witherspoon Street
(Nassau Street to Spring Street) and Reestablish On-Street Metered
Parking**

WHEREAS, on March 22, 2021, the Princeton Council adopted Ordinance No. 2021-6, which was enacted in response to the COVID-19 pandemic and to place Princeton's staff and officials in a position to continue to react quickly to evolving circumstances as various businesses in Princeton operate in compliance with State statutes, executive orders and administrative directives, by continuing to temporarily relax or suspend certain requirements presently set forth in Princeton's ordinances related to retail and personal service establishments, sidewalk cafés, outdoor dining, and motor vehicles, and to keep in place the process established in 2020 for staff and officials to efficiently implement additional measures as changing circumstances may warrant; and

WHEREAS, Ordinance No. 2021-6 explicitly authorizes the Mayor and Council by resolution to close all or parts of sidewalks, close all or parts of streets, suspend or alter parking regulations, block off parking spaces and loading areas, and/or reserve or re-designate parking spaces and loading areas as may be needed to enable all legitimate right-of-way users, retail businesses and retail food establishments to comply with any COVID-19 related requirements and limitations imposed by the State, including safe distancing recommendations and requirements for curbside pick-up; and

WHEREAS, Ordinance No. 2021-6 explicitly authorizes the Mayor and Council by resolution to allow outdoor dining areas to be expanded onto publicly-owned property; and

WHEREAS, Ordinance No. 2021-6 continues an *ad hoc* committee known as the

“COVID-19 Compliance Committee,” whose purpose *inter alia* is to identify issues related to or arising out of the various requirements and limitations imposed by Governor Murphy and/or the State legislature or administrative agencies; to recommend solutions to the Mayor and Council for their approval by resolution or ordinance as appropriate; and to grant certain administrative approvals in accordance with the terms of this ordinance and of *P.L. 2021, c. 15*; and

WHEREAS, the Compliance Committee has identified a number of modifications to the Witherspoon Street curbside pickup and dining configuration that it is recommending to the Council for approval, including but not limited to the repeal of designate curbside pick-up areas and the creation of on-street hybrid loading / metered parking spaces; and

WHEREAS, the Compliance Committee is recommending modifications to the metered parking time limits on Spring Street; and

WHEREAS, the Compliance Committee’s recommendations are summarized in a memorandum from the COVID-19 Compliance Committee dated May 20, 2021, a copy of which is attached hereto as Exhibit “A” and made a part hereof; and

WHEREAS, the details regarding the Compliance Committee’s recommendations for Witherspoon Street are depicted on the map or plan prepared by the Princeton Engineering Department dated May 20, 2021. a copy of which is attached hereto as Exhibit “B” and made a part hereof; and

WHEREAS, the Mayor and Council find that the Compliance Committee’s recommendations will advance the public health, safety and welfare; and

WHEREAS, the Mayor and Council therefore wish to approve the Compliance Committee’s recommendations.

NOW THEREFORE, BE IT RESOLVED, by the Mayor and Council of the

Municipality of Princeton in Mercer County, New Jersey, as follows:

1. The preamble to this resolution is hereby incorporated as fully restated herein.
2. The recommendations of the COVID-19 Compliance Committee described in Exhibit A attached hereto and depicted on Exhibit B attached hereto are hereby approved.
3. This resolution shall take effect immediately.

Councilperson	Absent	Present	1 st	2 nd	Yea	Nay	Abstain	Disqualified
Mr. Cohen		X			X			
Ms. Fraga		X			X			
Ms. Niedergang		X		X	X			
Ms. Pirone Lambros		X	X		X			
Ms. Sacks		X			X			
Mr. Williamson		X			X			
Mayor Freda		X						

I, Delores A. Williams, Municipal Clerk of Princeton, do hereby certify that the above is a true copy of a resolution adopted by the Mayor and Council of Princeton at a meeting held May 24, 2021.

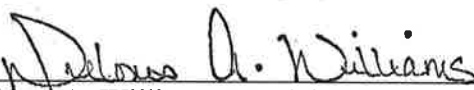

 Delores A. Williams, Municipal Clerk

ATTACHMENTS:

- Exhibit A Covid Committee Memo May 2021 (DOCX)
- Exhibit B Witherspoon Dining 5-2021 (PDF)



Municipality of Princeton

*Witherspoon Hall
400 Witherspoon Street
Princeton, NJ 08540-3496*

*Office of the Engineer
Telephone (609)921-7077
Facsimile (609) 688-2026*

*DEANNA STOCKTON, P.E., C.M.E.
Municipal Engineer
dstockton@princetonnj.gov*

MEMORANDUM

DATE: May 21, 2021

TO: Mayor and Council

FROM: COVID-19 Compliance Committee

RE: RECOMMENDATIONS FOR THE MODIFICATION OF CERTAIN OUTDOOR DINING AREAS, THE REPEAL OF CERTAIN CURBSIDE PICK-UP AREAS, THE RE-ESTABLISHMENT OF METERED PARKING IN THE MUNICIPAL RIGHT-OF-WAY ON WITHERSPOON STREET AND TULANE YARD, AND MODIFICATIONS TO TIME LIMITED METERED PARKING ON SPRING STREET

The COVID-19 Compliance Committee offers the following recommendations to modify activities within the municipal right of way on Witherspoon Street between Nassau Street (New Jersey State Highway 27), in the Tulane Yard, and on Spring Street. Exhibit B, attached, provides more detail regarding the changes proposed. While we anticipate that the proposed modifications will be implemented as stated, we advise that certain decisions may be made and or changed by the Committee during the installation and implementation process.

The Committee recommends repealing the provision which accommodated curbside pickup and loading activities along the western edge of the cartway of the Witherspoon Street right of way. Since its implementation in June 2020, the allowable activities in the curbside pickup have adapted to community needs from a temporary standing operation (with the driver staying in the vehicle) to a limited duration parking stay, while also accommodating commercial vehicle loading. As the volume of traffic and activity have increased on Witherspoon Street at the same time that CDC and New Jersey directives related to the pandemic have relaxed, there is a need to reallocate and better manage the space.

The Committee recommends reducing some of the on-street outdoor dining areas on Witherspoon Street, as shown in Exhibit B, to allow for on-street metered parking and loading activities to resume along the curb line.

- On the west and east sides of Witherspoon Street, provide a total of seven hybrid loading and on-street metered parking between the northerly curb line of Nassau Street and a point approximately one hundred forty feet north. Four 30-minute metered parking spaces will be activated on the west side of the road for this hybrid activity; three 3-hour

metered parking spaces will be activated on the east side of the road for this hybrid activity. It is proposed that commercial vehicle loading activities only may occur before 12 pm Monday through Saturday. Three-hour metered parking will begin at 12 pm Monday through Saturday and end per existing municipal code. Commercial loading is not allowed in these spaces on Sundays.

- On the west side, establish a curbside commercial loading zone on Witherspoon Street from a point approximately one hundred eighty-five feet north of Nassau Street to a point approximately one hundred feet northerly. Parking of noncommercial vehicles is prohibited in this location.
- On the east side, establish two thirty-minute metered parking spaces between the southerly curb line of Spring Street and a point approximately seventy-five feet southerly.

In the Tulane Yard, two metered parking spaces shall be established parallel to the J. McLaughlin building with a thirty-minute time limit instead of the curbside pickup area.

On Spring Street between Witherspoon Street and South Tulane Street, five parking meters will be reprogrammed for 30-minute time limits instead of 3-hour time limits.

We appreciate Council's consideration of these recommendations at its May 24, 2021 Council Meeting. Please contact Deanna Stockton, Municipal Engineer, or Derek Bridger, Zoning Officer, if you have any questions or require additional information.

Attachments

Cc: Bernard Hvozdovic, Administrator
Delores A. Williams, Clerk
Police Chief Christopher Morgan
Michael LaPlace, Planning Director
Derek Bridger, Zoning Officer
Dan Van Mater, Director of Public Works
Joe Novak, Fire Official
Trishka W. Cecil, Municipal Attorney

EXHIBIT B - Witherspoon Street and Spring Street Changes
May 21, 2021

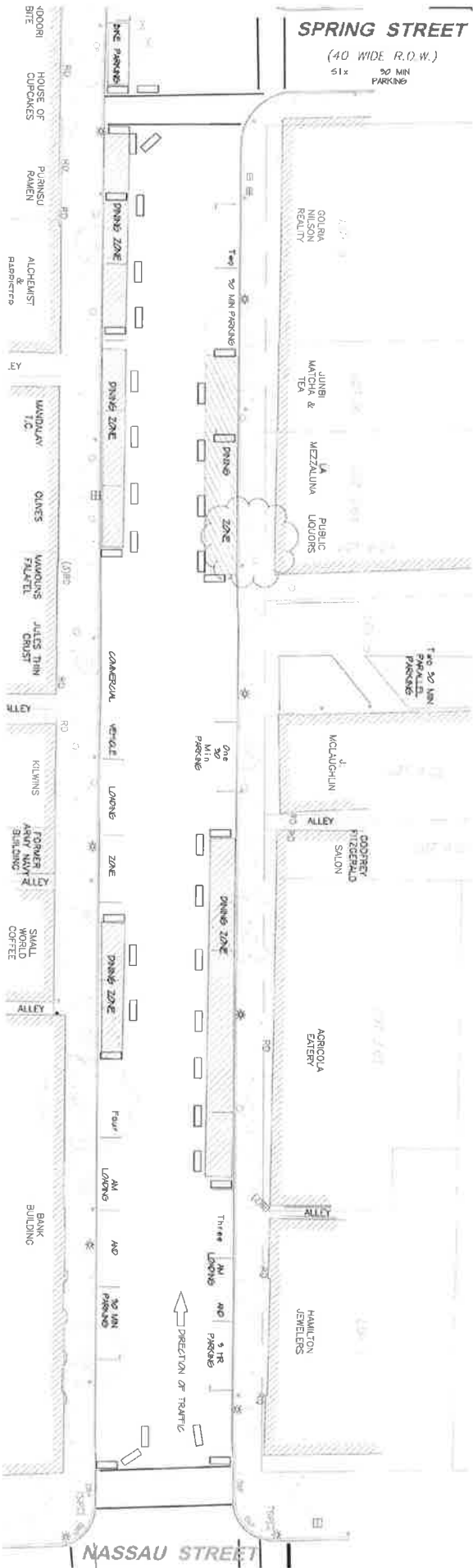

- Reconfigure diagonal spaces in Tulane Lot to provide 2 parallel parking 30 minute spaces.
- Reprogram 5 meters on Spring Street between Witherspoon and South Tulane from 3 hours to 30-minute time limits.
- Witherspoon East Side:
 - Move blocks on southern end of Agricola to reestablish one more parking space to create 3 in a row.
 - Reprogram 3 meters for loading until 12 pm M-SAT.
 - Remove blocks on north end by Spring to reestablish 2 parking spaces in front of Realtor; shift northern end of La Mezzaluna blocks as needed. Reprogram these 2 meters for 30-minute time limits.
- Witherspoon West Side:
 - Maintain 4 parking spaces south of Small World. Ensure that 2 spaces north of Small World are not in a dining area, as they will become part of the loading zone.
 - Reprogram the 4 meters south of Small World to be loading until 12 pm M-SAT; reprogram 2 of the meters from a 3 hour to a 30-minute time limit; so all will be 30-minute time limit. North of Small World, these 2 meters can be removed, as this is part of the new loading zone.
 - Remove blocks as necessary to leave a shared dining section for Mamouns and Olives on the southern end of the A&B dining area. This area will extend to the property line between Olives and Mamouns.
- Witherspoon Both sides:
 - Replace curbside pickup signage with No Standing or Stopping signage (or No Parking Anytime if the other type is unavailable).

EXHIBIT B - Witherspoon Street and Spring Street Changes
May 21, 2021

- Remove signs that face the wrong direction (holdovers from when the road was 2-way).
- Install signage to be created regarding the new parking time limits. Engineering will create new signs and get them printed by FLM, for installation by DPW.